

# Operating Manual

## Sink Unit for Ice Cream Scoops with Shower and Optional Dryer





## Table of contents

<b>1</b>	<b>Preface</b> .....	<b>4</b>
1.1	Introduction .....	4
<b>2</b>	<b>Safety instructions</b> .....	<b>5</b>
2.1	Symbols und notes .....	5
2.2	Basic safety instructions .....	6
2.3	Intended use .....	6
<b>3</b>	<b>Description of the device</b> .....	<b>7</b>
3.1	General .....	7
3.2	Technical data .....	7
<b>4</b>	<b>Assembly instructions</b> .....	<b>8</b>
4.1	Assembly of the sink unit .....	8
4.2	Water connection .....	8
4.3	Waste water .....	8
4.4	Compressed air connection .....	9
<b>5</b>	<b>Operating instructions</b> .....	<b>10</b>
5.1	Normal operation .....	10
<b>6</b>	<b>Maintenance instructions</b> .....	<b>11</b>
6.1	Cleaning .....	11
6.2	Maintenance .....	11
6.3	Trouble shooting and elimination .....	12
6.4	Wear and spare parts .....	13
6.5	Declaration of conformity .....	14
<b>7</b>	<b>Accessory</b> .....	<b>15</b>
7.1	Accessory parts (optional) .....	15

# **1 Preface**

## **1.1 Introduction**

Thanks for your confidence and congratulations on the purchase of your new sink unit for ice-cream scoop with shower GEPETTO® (and optional dryer).



For achieving maximum hygiene in operation, we have attached particular importance to the fact that all components are easy to clean.

Please read this operating manual with all its information and instructions carefully and keep it in a safe place for later references. We are sure, you will have much pleasure and success with your new sink unit if you follow all the instructions given in this manual.

## 2 Safety instructions

### 2.1 Symbols und notes

Please pay attention to the explanation of the following symbols and references. The same are classified according to ISO 3864-2.

 <b>CAUTION</b>	
	Indicates a potentially dangerous situation. If the information is not followed, damage to property as well as slight or moderate bodily harms may be the consequence.

 <b>WARNING</b>	
	Indicates a potentially dangerous situation. If the information is not followed, death or very serious bodily harms (disability) may be the consequence.

<b>NOTE</b>	
	Indicates general instructions, useful tips for users and work recommendations which, however, have no influence on safety and health of the personnel.



## 2.2 Basic safety instructions

These operating instructions serve as basis for using and operating the shower and the optional dryer according to safety regulations. These operating instructions, in particular the safety instructions, are to be observed by all persons working on or with the sink unit. Furthermore are to be followed the rules and regulations for prevention of accidents being applicable on site. The operating instructions are always to be kept in the place of application of the sink unit.

**The company GEPETTO-EIS is not liable for accidents which occur when operating, cleaning and maintaining the sink unit without observing the safety instructions specified in this operating manual!**

## 2.3 Intended use

Shower and dryer are intended for cleaning and drying ice-cream scoops.

 <b>CAUTION</b>	
	Do not misuse the shower/dryer for other purposes! Every misuse can cause injuries and/or equipment damage!

## **3 Description of the device**

### **3.1 General**

The sink unit is a device to be used for cleaning ice cream scoops by means of water (and compressed air).

The sink unit consists of following elements:

- basin (different types)
- shower unit incl. stop-cock
- dryer unit (optional)
- outlet pipe
- insert plate (only in case of longitudinal basin)

### **3.2 Technical data**

- Dimension (L x W x H): 275 x 120 x 518 mm
- Material: high-quality special steel
- Functionality: with water pressure/  
dryer pneumatically
- Weight: approx. 2 kg, depending on type

## **4 Assembly instructions**

### **4.1 Assembly of the sink unit**

- Take the sink unit carefully out of the packaging.
- For avoiding possible damage to the sink, never use cutter knives for opening the package!
- If the sink unit has been purchased with wall attachment, insert two screws at suitable space on the place where the sink unit is to be mounted. Suspend the wall attachment. Connect all necessary cables as follows:

### **4.2 Water connection**

- The sink unit needs drinking water connection with water pressure of 1-4 bar.
- The connection at the stop-cock of the shower has been provided with a 3/8 inch external thread.
- Connect your water connection to the shower using a standard sanitary hose (hose no part of delivery).

### **4.3 Waste water**

- To the waste water connection you can connect a hose with an inner diameter of 20 mm and secure it with a hose clip (hose no part of delivery).





#### **4.4 Compressed air connection**

- In case of an optionally installed dryer, the sink unit requires compressed air with an air pressure of approx. 4-6 bar (max. 15 bar).
- At the flow controller of the dryer has been provided a connection for a hose line (D6x4 mm).
- Connect the dryer to your compressor by means of suitable hose line.
- Set the operating pressure at the pressure reducing regulator to approx. 4-6 bar. Please observe for this purpose also the operating instructions of the manufacturer.

Insert the sink unit from above into the wall attachment or alternatively into the work plate. Make sure that no cable is kinked or wedged-in.



## 5 Operating instructions

 <b>CAUTION</b>	
	The sink unit can only be operated by instructed and trained persons.

### 5.1 Normal operation

- Press the ice-cream scoop, with the inside facing downwards, onto the pressure tappet of the shower unit so that water, flowing out from bottom and top, washes off from the scoop any adherence of ice.
- With the ball valve mounted in the supply line you can regulate the water flow a little.
- If your sink unit is equipped with the optional dryer, press the ice-cream scoop, with the inside facing down, onto the pressure tappet of the dryer so that the scoop will be dried by airflow from bottom and top.
- Via the flow regulator mounted in the supply line and the pressure gauge of your compressor, you can adjust the air volume and the operating pressure according to your requirements.

## 6 Maintenance instructions

 <b>CAUTION</b>	
	If the sink unit is equipped with a dryer, the system is to be depressurized before executing maintenance work for avoiding injuries!

### 6.1 Cleaning

- Pull the water outlet tube (if used) out of the drain and let the water flow out of the sink.
- If the sink is equipped with an insert plate\*, remove it for eliminating any particles such as nut or chocolate sprinkles.
- Clean all parts with a damp cloth.
- If you clean the basin or its built-in parts with detergent, make sure that all parts are rinsed thoroughly with clean water so that no detergent residues can contact the ice-cream scoop.

\*optional, see point 7 Accessories

### 6.2 Maintenance

- We recommend to check the seals in regular intervals and to replace them if necessary.

### 6.3 Trouble shooting and elimination

<b>Trouble</b>	<b>Possible cause</b>	<b>Solution</b>
Excessive water squirts out of the shower	Water pressure is too high	Mount pressure reducing regulator
Insufficient water comes out of the shower	Ball valve is not opened completely	Open the ball valve completely
No water comes out of the shower	Ball valve below the shower is closed	Open the ball valve
No water comes out of the shower	Water supply is turned off	Turn on the water supply
No or insufficient air comes out of the dryer	Line is snapped off	Ensure that the hose is installed without any kinks
No or insufficient air comes out of the dryer	Flow controller is closed too much	Open the flow controller
No or insufficient air comes out of the dryer	Connection at compressor is too much turned off	Turn on the connection at the compressor

## 6.4 Wear and spare parts

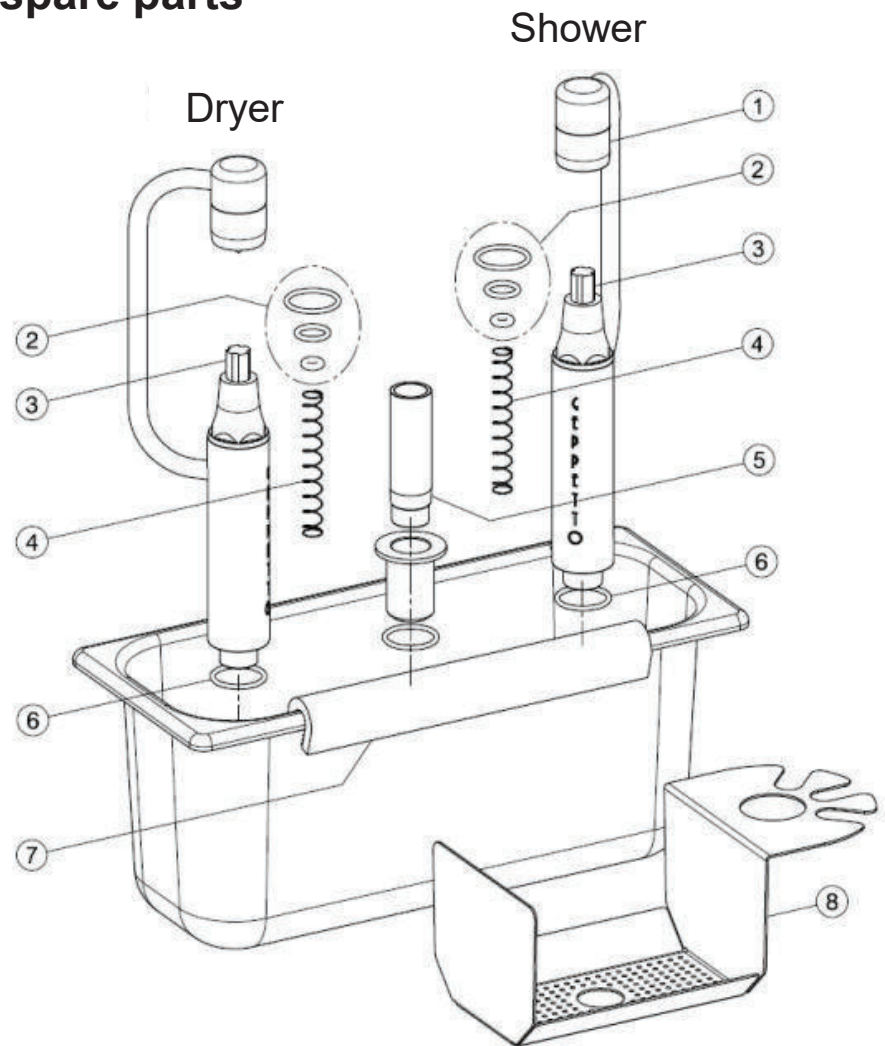

Item	Designation	Article No .
1	Perlator	23156-47
2	Sealing ring set	23156-65
3	POM tappet	23156-11
4	Compression spring	23156-43
5	Overflow pipe	23156-38
6	O-ring	23156-28
7	Beating rubber roll	23156-46
8	Insert plate	23156-35
-	Sealing ring and wearing parts kit complete, consisting of No. 2, 3 and 4	23156-65a

## 6.5 Declaration of conformity

Although the sink unit for ice-cream scoops with shower and optional dryer does not come in contact with foodstuff, all parts comply with regulation EG 2023/2006 (good manufacturing practice for materials and articles intended to come into contact with food).

Shower and dryer are pressure equipment according to directive 2014/68/EU (due to classification without CE-marking) and are developed and produced according to good engineering practice.

GEPETTO EIS GmbH  
Visbeker Str.51  
27793 Wildeshausen  
GERMANY  
Tel. +49 (0) 4431-9455606  
info@gepetto-eis.de

Wildeshausen, 01.01.2021

---

Ottaviano Ienco  
Managing director  
Gepetto-Eis GmbH



Visbeker Str. 51 27793 Wildeshausen  
Tel. 04431-9455606 Fax: 04431-738398  
e-Mail: info@gepetto-eis.de

## 7 Accessory

### 7.1 Accessory parts (optional)

- 23156-23 Micro-line filter (for the dryer,  
when using an oil-lubricated compressor)
- 23156-35 Insert plate (see page 13, item 8)

We wish you a lot of fun with your new sink unit for ice-cream scoops!

Your GEPETTO-Eis Team!





## **Geppetto Eis GmbH**

Visbeker Str. 51

27793 Wildeshausen

GERMANY



Tel.: +49 (0) 4431 - 94 55 606

Fax: +49 (0) 4431 - 73 83 98

E-Mail: [info@geppetto-eis.de](mailto:info@geppetto-eis.de)

Website: [www.geppetto-eis.de](http://www.geppetto-eis.de)